

Mushko Building Solutions

Mushko Building Solutions covering domains are:

- Information Communication Technologies [ICT]
- Building Management Systems
- Extra Low Voltage [ELV] Systems

Information Communication Technologies [ICT]

ICT plays pivotal role and considers as backbone of Mushko Building Solutions [MBS]. In totality Mushko offers most comprehensive, scalable and integrated ICT solution that addresses Point-to-Core with latest technologies.

Being oldest and only partner of Hewlett Packard (HP) in Pakistan, who can offer support of complete HP range, Mushko has positioned as largest ICT solution provider.

HP has completed its acquisition of 3Com Corporation at an enterprise value of approximately \$2.7 billion and has integrated 3Com's network switching, routing and security solutions with its existing [HP ProCurve solutions](#), created a comprehensive portfolio for customers. Combined with HP's global reach, the expanded portfolio solidifies HP's [Converged Infrastructure strategy](#), which is built on the integration of servers, storage, networking, management, facilities and services. With this integration, customers will be able to simplify their networks, deploy an edge-to-core network fabric for the enterprise and improve IT service delivery capabilities.

3Com also brings to HP network security capabilities through its TippingPoint portfolio. Together, HP is able to deliver one of the broadest network technology capabilities in the market to meet customer needs well into the future.

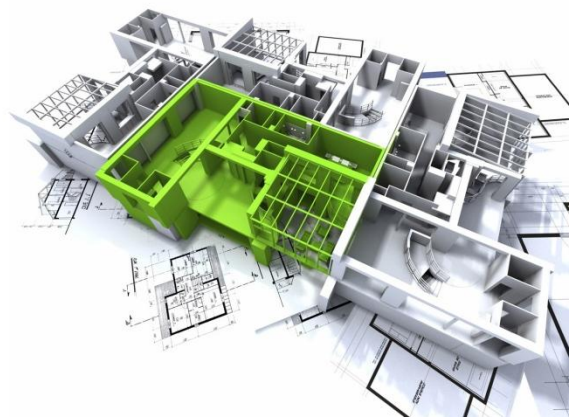

Building Management Systems

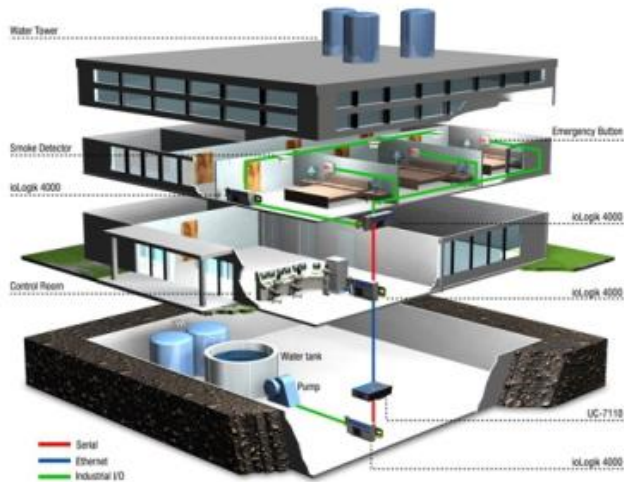

Energy cost and systems efficiency; are world's foremost recognized challenges. The U.S. Energy Information Administration's (EIA) Annual Energy Outlook for 2006 shows that energy costs rose 31% from 2003 to 2005. Add to this scenario the fact that 70% of these buildings are at least 20 years old, and the average building uses 20% more energy than necessary.

Local statistics reflect, Cooling consumes approximately 60% of energy and remaining 40% of energy shared in; Lighting, IT networks, Computing, Printing, Appliances and Landscaping. To address these challenges the most important element is to establish Key Performance Indicators (KPIs), reporting, logging and trending, which remain impossible unless real-time monitoring and controlling of building systems. Mushko Building Solutions covers;

- HVAC Controls
- Lighting Controls
- Elevator Controls, and
- ELV systems

Over unified ICT infrastructure.

Extra Low Voltage [ELV] Systems

Mushko Building Solutions' ELV portfolio provides freedom-of-choice to customers to choose Life Safety and Security solutions from multiple manufacturers and integrate them over single iBMS portal via Open-Standards ICT.

This ends the vendor-dependency era and establishes better scale of economy, efficiency and reduced OPEX for customers. Our ELV offers:

- Fire Detection and Alarm System
- Emergency Voice Evacuation System
- Automatic Fire Suppression System
- CCTV Surveillance with Video Analytics
- Access Control and Visitor Management
- Speedgates, Turnstiles and Bollards
- Parking Management System
- Utilities / Automatic Metering Infrastructure
- Remote Genests Monitoring
- Command and Control Center



Remote Gensets Monitoring (RGM)

A revolutionary solution for organizations, operating on multiple locations (bank branches, cellular BTS... etc.) and keen to reduce operational expenses.

Economizing consumer banking, automating cellular BTS or monitoring WiMax hotspots are the Level One priority for respective industries. As regular practice in Pakistan, each branch/node has minimum one generator (diesel, petrol) – Higher the number of branches, greater would be chances of negligence, fuel stealing and reduced performance of assets – thus resulting increase in Operational Expenses. Mushko RGM solution connect branches/nodes to a central online web-portal, where you can see; ON/OFF Status, Fuel Level, Refilling, Fuel Consumption, Reporting and Trending.